

0 +  
Months

Carrying Capacity  
Upto 18 kg

User's Manual

Babyhug Opal 3in1 Cozy Rocker Sleeper

Style code - NUBF028

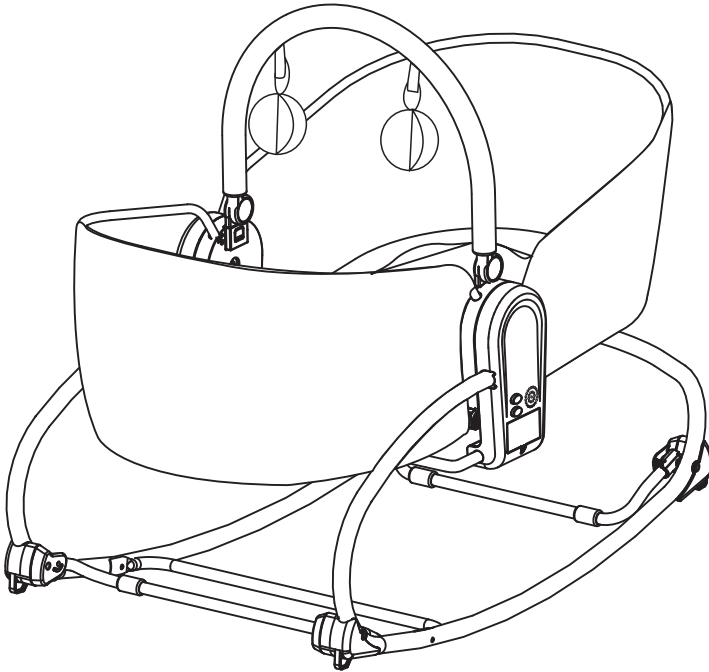

**babyhug®**

baby rocker

- Toy bar
- 3 in 1
- Music
- 3 position backrest

**Parts come out of box**

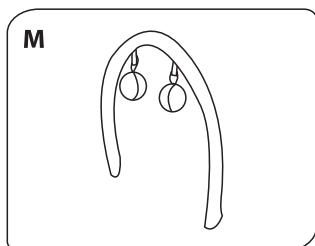
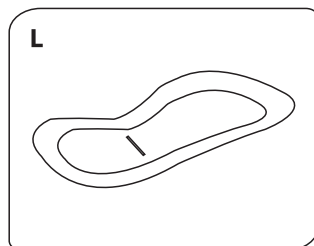
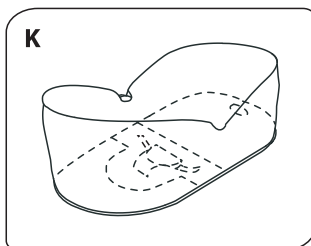
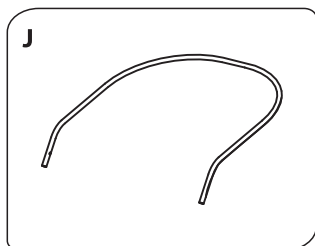
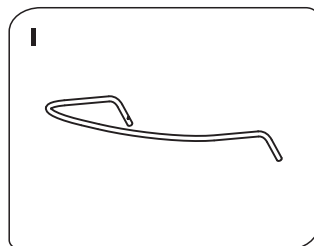
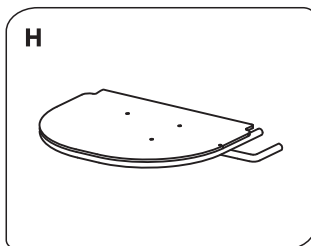
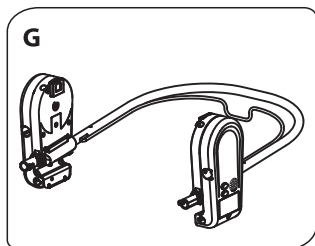
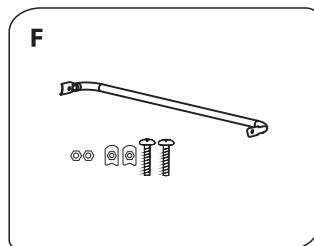
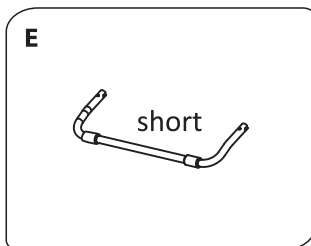
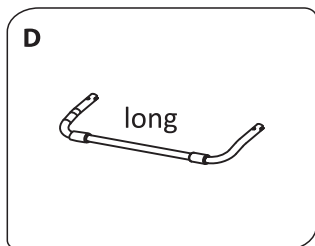
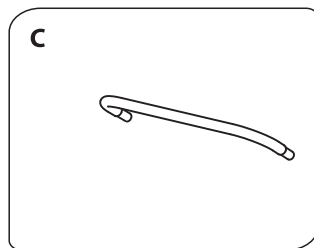
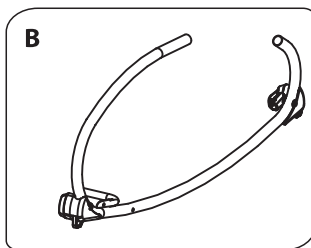
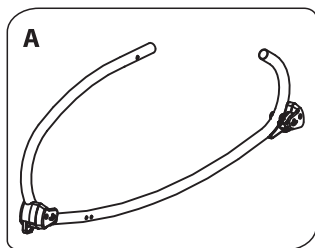

1

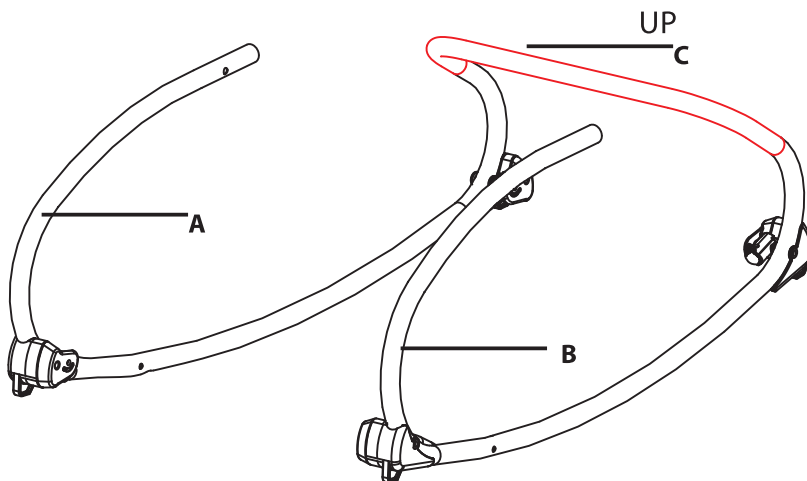

2

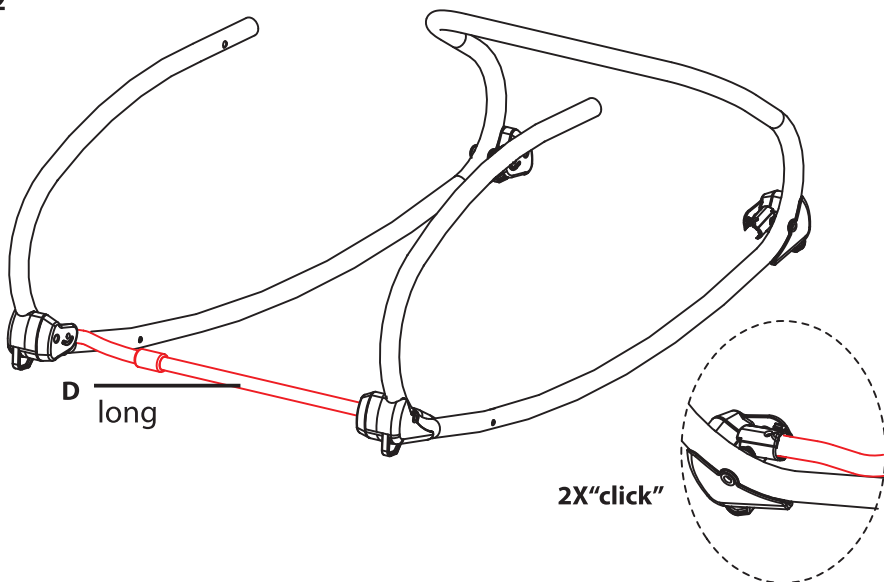

3

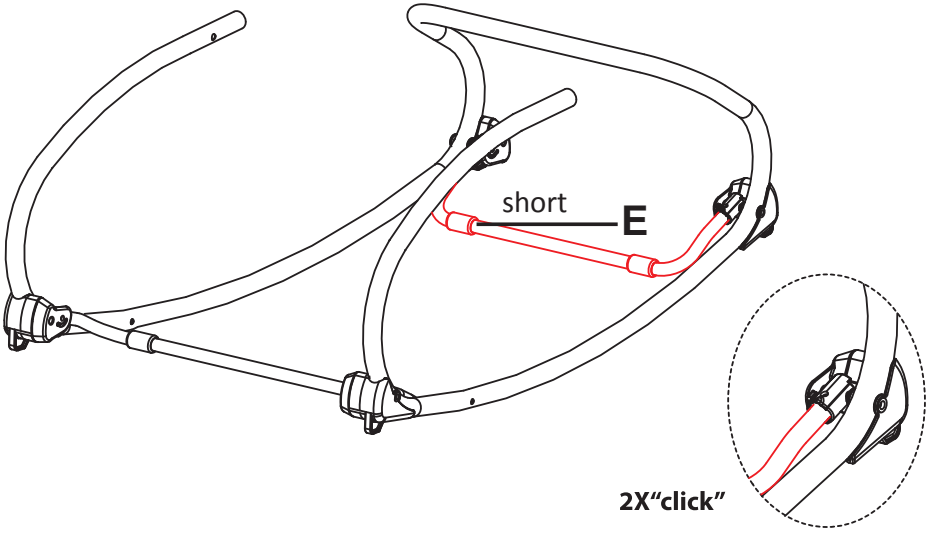

4

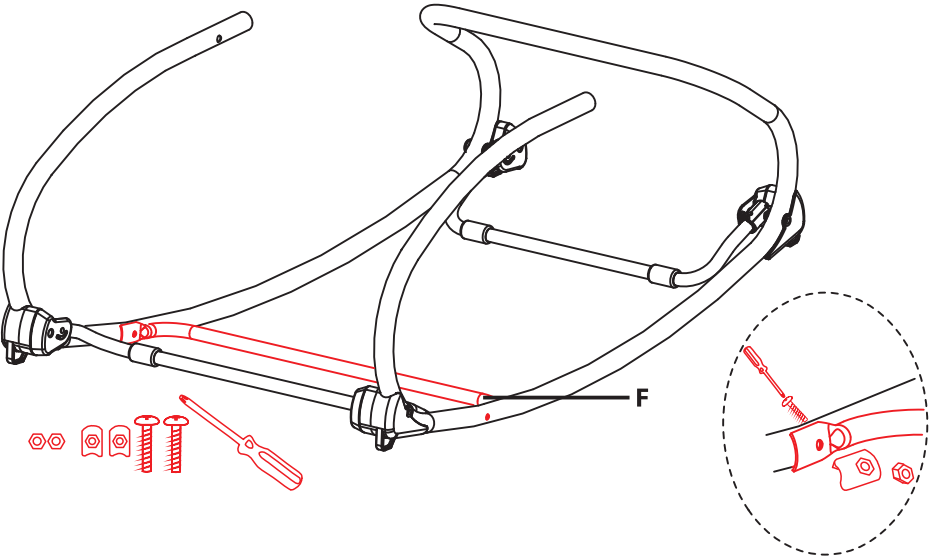

5

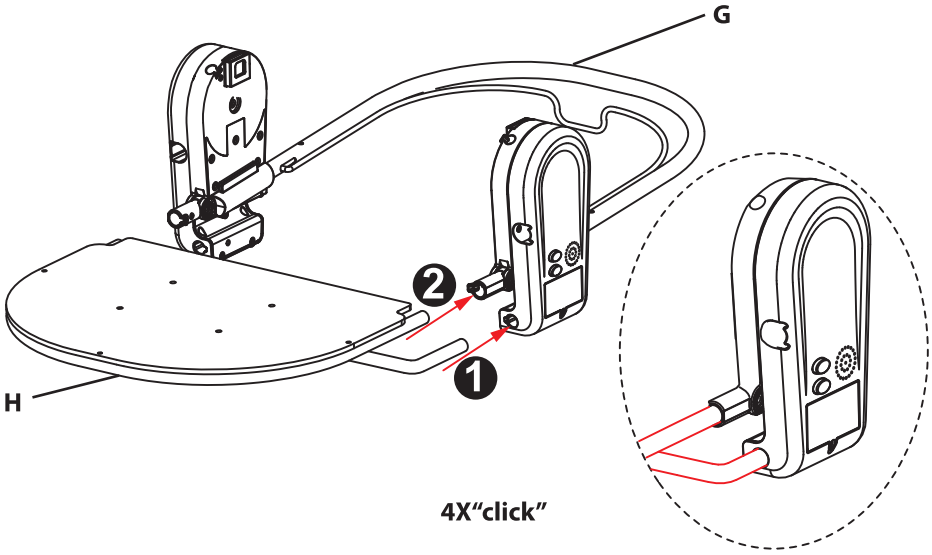

6

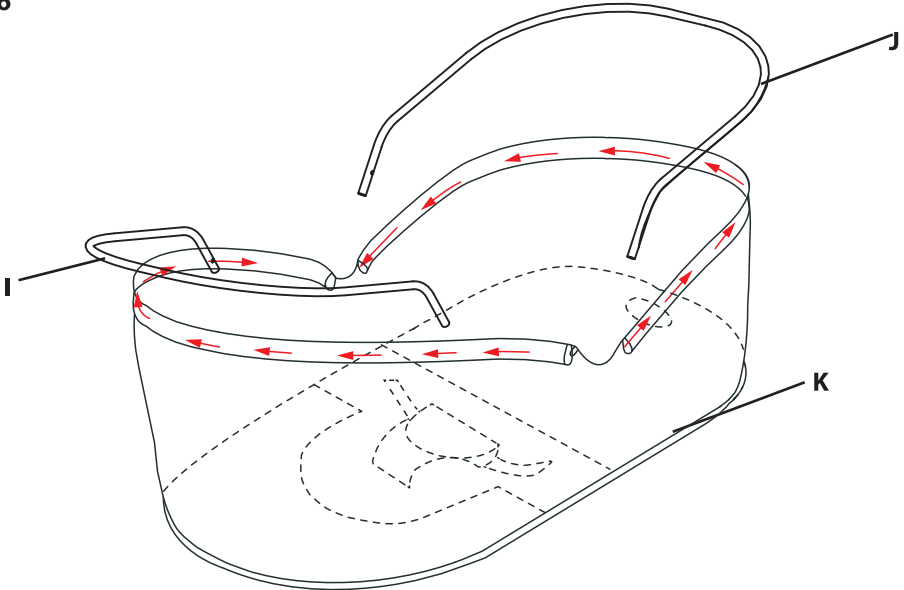

7

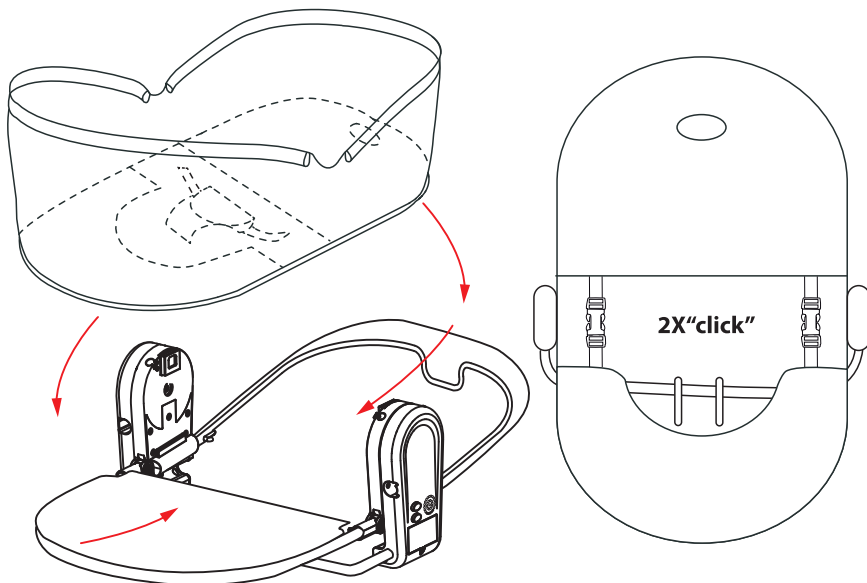

8

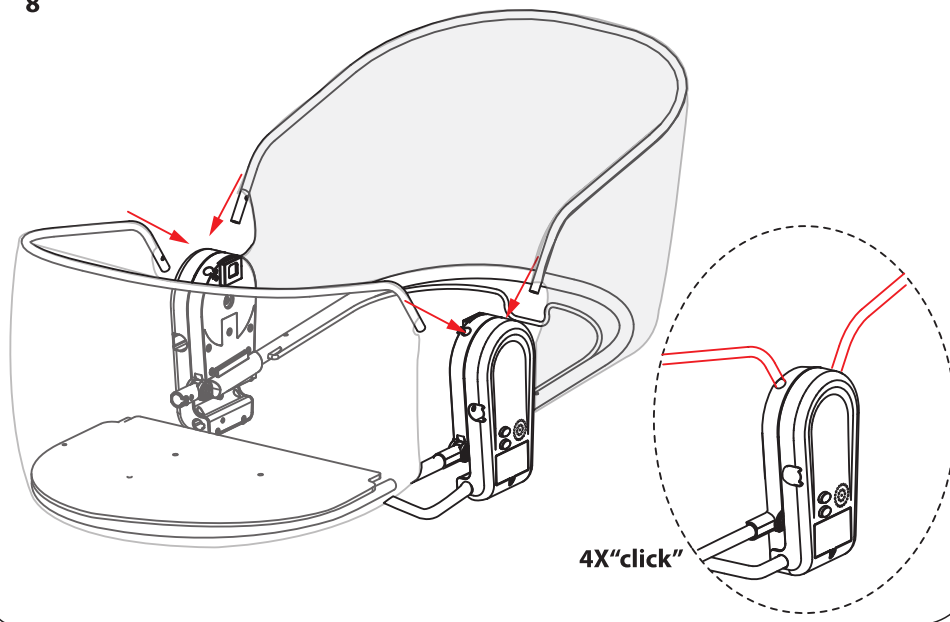

9

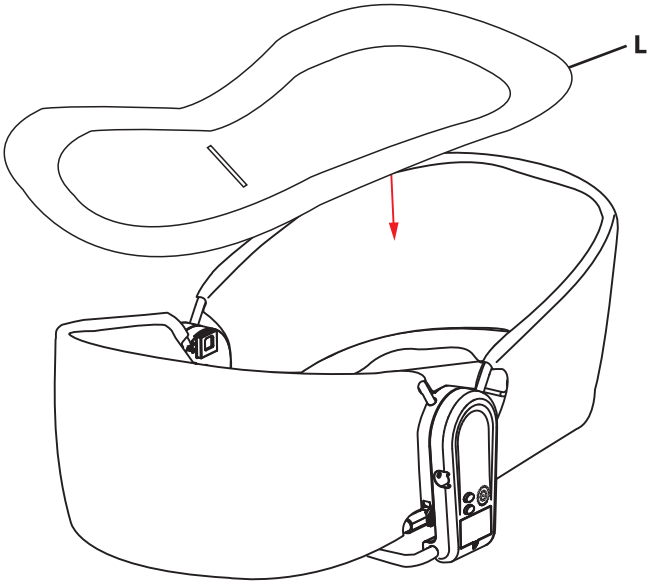

10

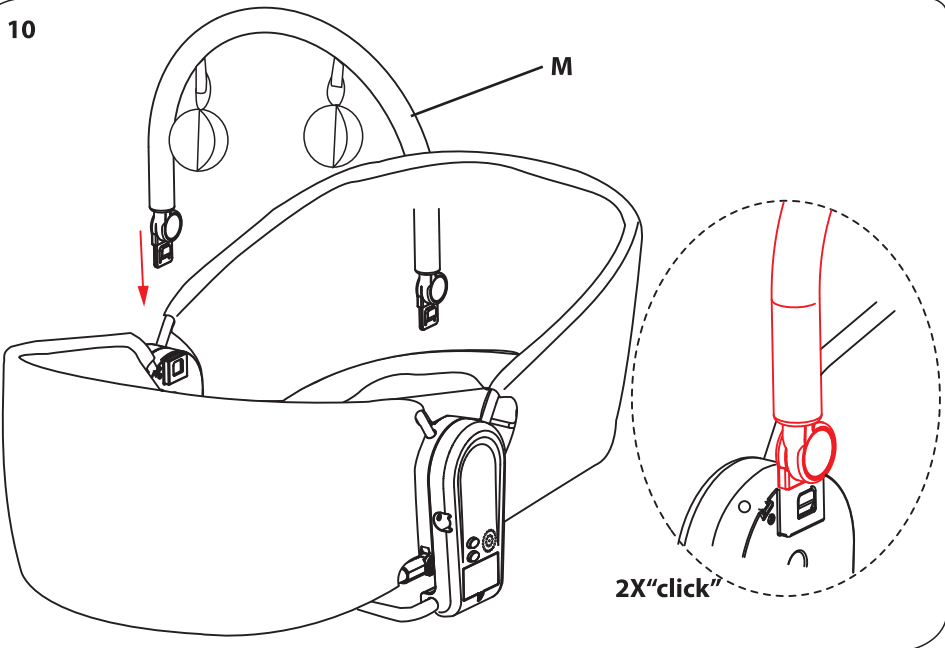

11

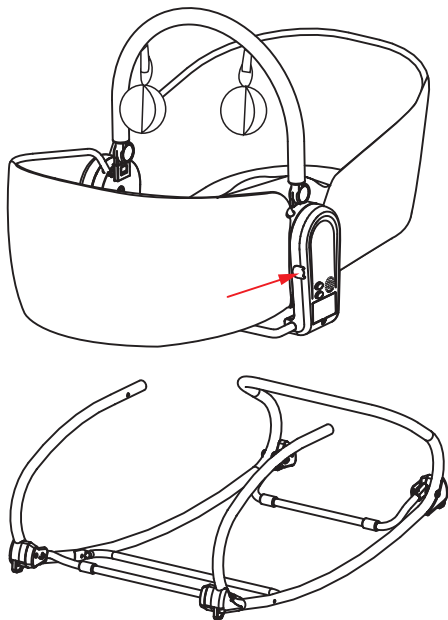

2X "click"

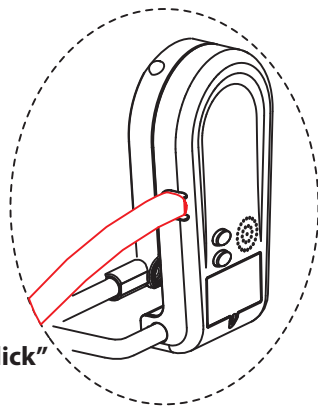

12

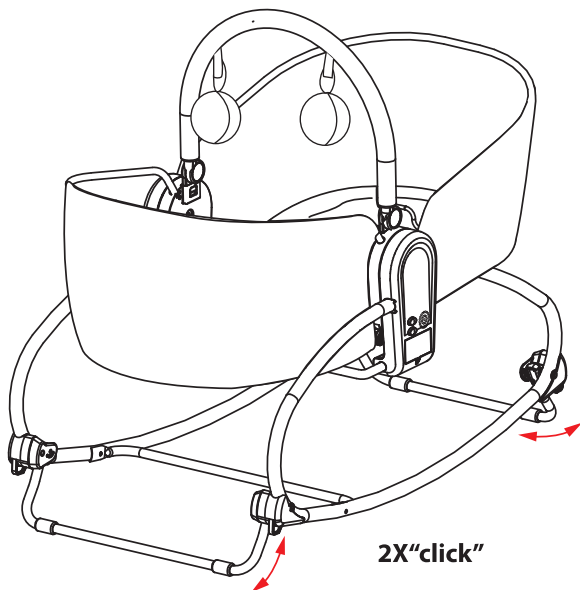

2X "click"

13

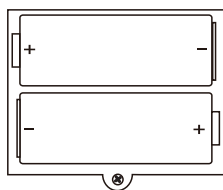
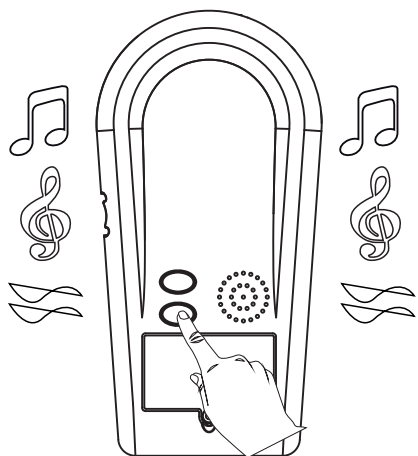

2X 1.5V AA SIZE

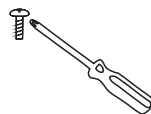
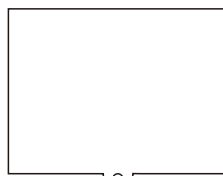

14

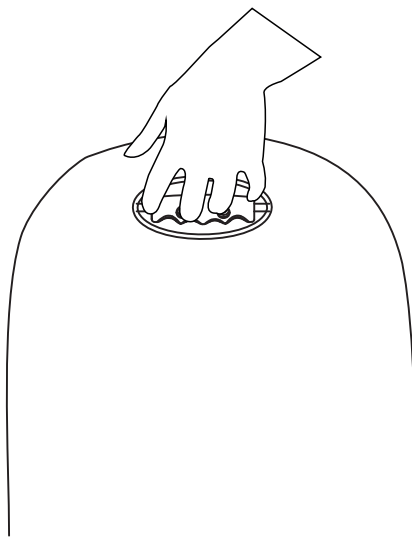
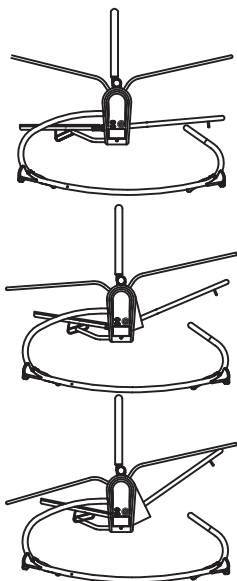

15

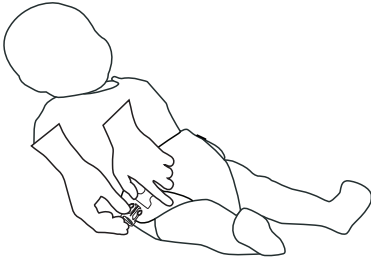

**2X“click”**

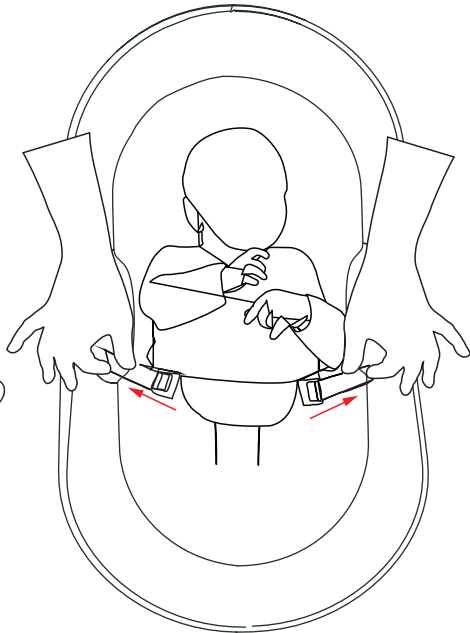

16

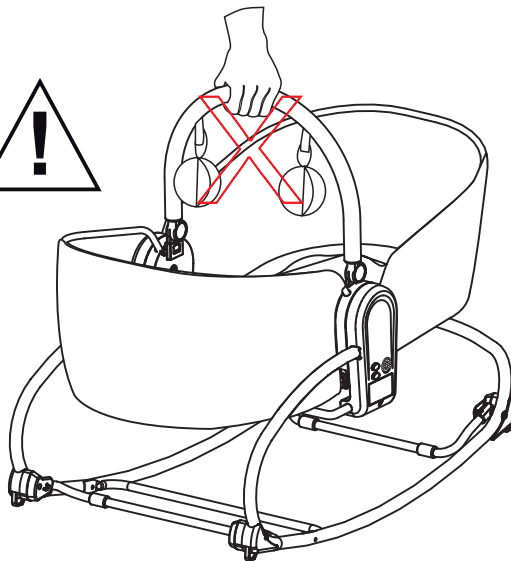

**Never lift the item from the toy bar!**

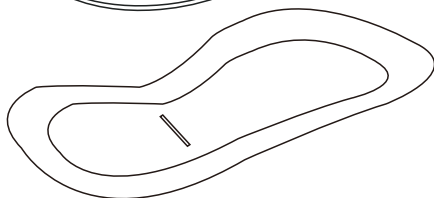
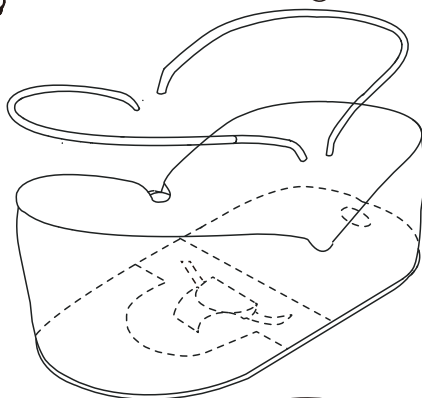
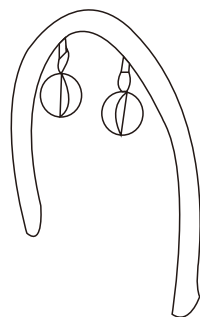
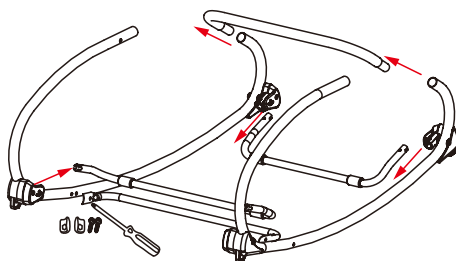
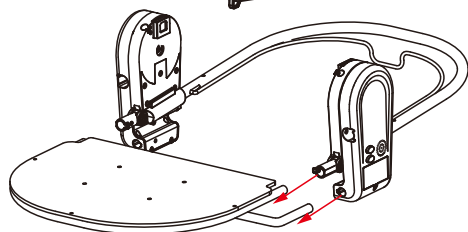
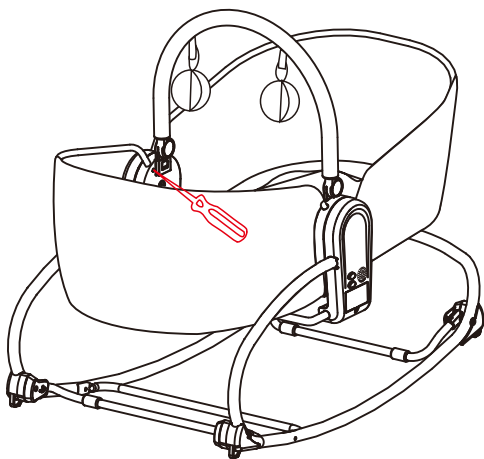

## Washing instructions

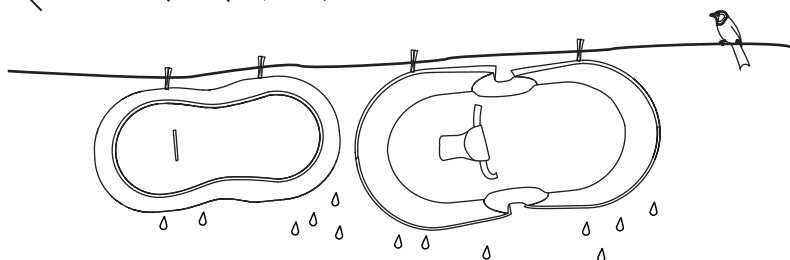

## Warning

IMPORTANT: Keep for future reference.

Read all instructions before using the product.

- The maximum weight of the child when used as Napper is 9Kg/20lbs.
- The maximum weight of the child when used as a "Seat" is 18Kg/40lbs.
- Adult assembly required.
- Remove all packaging materials before use.

## Warning



- Never leave the child unattended.
- Do not use the product in "Napper" or "Rock & Play" modes once the child can sit unaided or when reached the weight of 9Kg/20lbs whichever comes first.
- This product is not intended for prolong period of sleeping.
- The product does not replace a cot or a bed. Should your child need to sleep, then it should be placed in a suitable cot or bed.
- Child's activity may move product, use only on floor. Never use on any elevated surface.
- Always use the restraint system.  
The toy arm is not a carry handle. Never use the toy arm to carry the product.
- Toy arm should be removed from the seat when child start to sit independently. The hole  
should be covered by its attached cap.
- Check this product regularly that all assembly fittings are tightened properly before use.
- Do not use if any parts or screws are loose or missing or if there are any signs of damage or broken parts. Do not substitute, modify or alter parts. Contact the manufacturer if replacement parts or additional instructions are needed.
- NEVER add an extra padding, pillow or comforter. Use ONLY the pad and head support provided by manufacturer.
- Always use the head support when it is attached to the pad, according to the manufacturer's instructions.
- Any load placed on the canopy affects the stability of the product and can break the canopy.
- Never assemble/dismantle the canopy while the baby is in the product to avoid injuries.
- Always keep fingers away from moving parts when folding / unfolding the canopy to prevent entrapment or pinching.
- The canopy should be removed from the seat when child starts to sit independently.

### **And don't forget these safety rules**

- Do not place this product near a window or a patio door where a child could reach the cord of a blind or curtain and be strangled.
- Young children should not be allowed to play unsupervised in the surrounding of the product.
- Don't use the body of the product without its frame.
- Keep away from fire.
- Do not attach any toys or accessories on the product that has a string or rope.
- Batteries should be replaced by adults only.
- Do not mix old and new batteries.
- Non-rechargeable batteries are not to be recharged.
- Rechargeable batteries are to be removed from the product before being charged.
- Rechargeable batteries should be charged under adult supervision only.
- Do not mix alkaline, standard (carbon-zinc) or rechargeable (nickel-cadmium) batteries
- Exhausted batteries are to be removed from a product.
- Do not burn batteries. Dispose of batteries in a safe and appropriate manner.
- Use only batteries of the same or equivalent type as recommended.
- Batteries are to be inserted with the correct polarity.
- The supply terminals are not to be short circuited.
- Please note: Batteries may leak fluid that can be harmful to your baby and the product.
- We strongly recommend using only high-quality alkaline (dry) batteries.
- Remove the batteries for long-term storage or periods of non-use.

---

**Imported & Marketed by**

Brainbees Solutions Pvt. Ltd.  
Corporate & Registered Office Address:  
Rajashree Business Park, Plot No: 114,  
Survey No. 338, Tadiwala Road,  
Near Sohrab Hall, Pune 411 001

**Customer Care No. :**

020-46608179

**E-mail:**

customercare@brainbees.com

**Customer Care Address:**

Same as Importer's address

Made in China