

User Manual

Babyhug Smart n Silent Electric Breast Pump

Style Code: FNBF021



babyhug®

breast pump

Please read the instructions carefully before using and keep for future reference

Catalog

1. Button and Function
2. Components and Names
3. Installation
4. How to Use the Breast Pump
5. Attentions
6. Storage and Heating of Breast Milk
7. Disinfection Methods

Button and Function

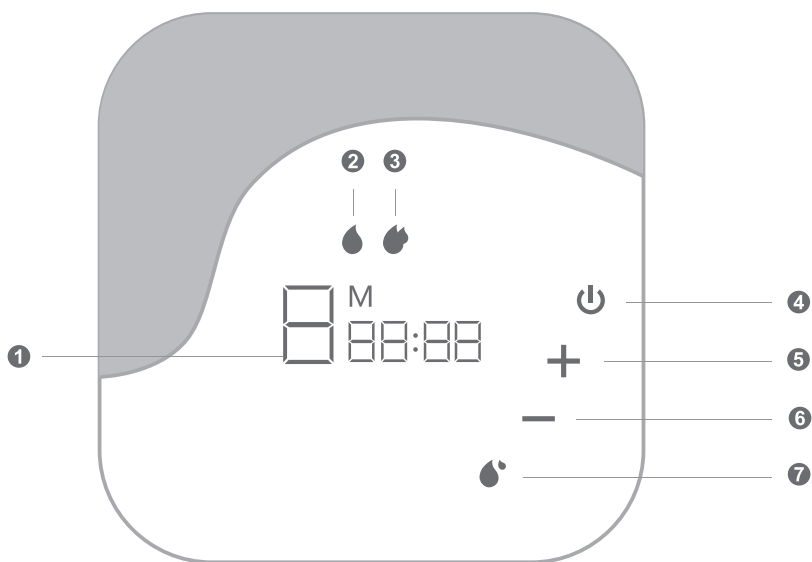

1. Time Display and Level Indicator
2. Normal Suction Mode
3. Residual Milk Extraction Mode
4. On-Off Key

5. Level UP Key
6. Level Down Key
7. Mode Switch Key

88:88 Time display and level indicator

💧 To switch between modes

🔌 On-off key (Press to On/Off)

🔥 Residual milk extraction mode: 6 levels

💧 Normal suction mode: 4 levels for stimulation and 5 levels for milk extraction

Components and Name

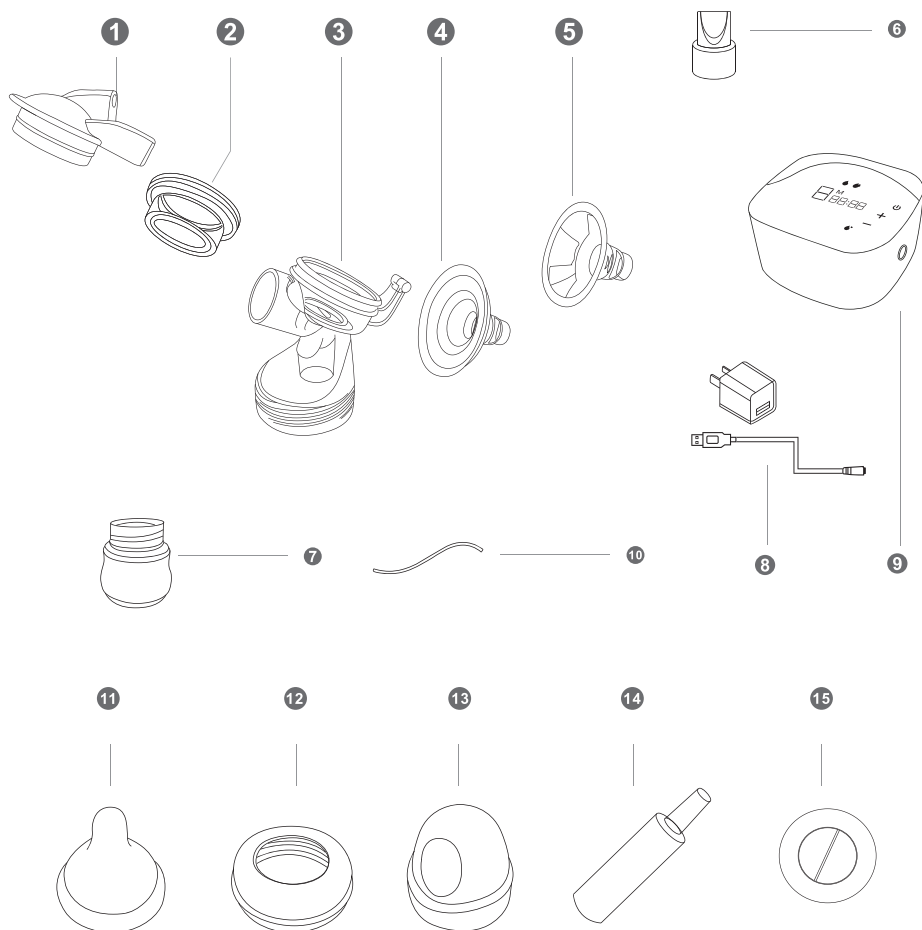

① Upper Cover (PP)

④ Horn Mouth

⑦ Feeding - Bottle (PP)

⑩ Connecting Tube

⑬ Bottle Cap (PP)

② Suction Silicone

⑤ Horn Mouth Silicone

⑪ Nipple (Silicone)

⑭ Tube Connector

③ Breast Pump Tee (PP)

⑥ Suction Valve (Silicone)

⑨ Electric/Suction Unit (ABS)

⑫ Screw Cap (PP)

⑮ Dust-proof Cap (PP)

Installation

⚠ Before assembling the breast pump, please sterilise all parts and make sure your hands are clean.

STEP 01

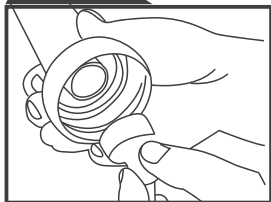

Fix the suction valve on the breast pump tee, and the top of the suction valve can rotate in any direction (ensure the suction valve is fully pushed-in)

STEP 02

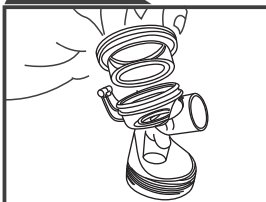

Install the suction silicone into the breast pump tee.

STEP 03

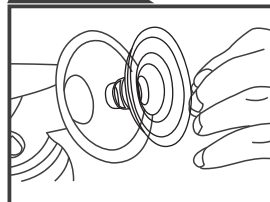

Install the horn mouth to the breast pump tee. And fix the horn mouth silicone.

STEP 04



Place the upper cover and screw clockwise.

STEP 05

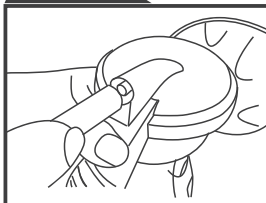

Insert the connecting tube into the suction hole on the upper cover. Make sure it is fully inserted.

STEP 06



Fix the assembled upper unit to the feeding bottle and screw up tightly.

STEP 07

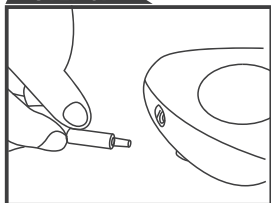

Insert the tube connector in to the electrical/suction unit. Make sure it is fully inserted.

STEP 08

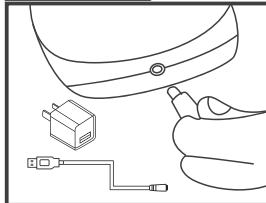

Insert the USB end of the wire in to adaptor and the other end into the electrical/suction unit. Plug the adaptor to the electrical socket. Make sure it is fully inserted.

STEP 09

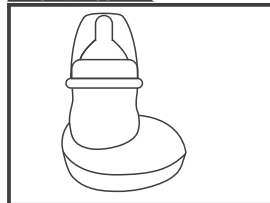

Your electrical breast pump is ready to use. Once you extract the milk, you can fix the screw cap and nipple to the feeding bottle and feed the baby. In case you do not want to feed immediately, you can store the breast milk in the refrigerator. Wash the components of the breast pump immediately after use. It might be difficult to clean once the breast milk dries up.

How to use the Breast Pump

Instructions

Before assembling the breast pump, please sterilise all parts and make sure your hands are clean. Assemble the breast pump according to the instructions provided. Use the breast pump in the stimulation mode. For extracting, change to extraction mode, sit up and slightly forward (do not lie down or tilt the breast pump). Align the silicone horn hole to the nipple and press it tightly and make sure there is no gap for air to escape.

ON - OFF Key

When power on, the breast pump by default starts in the stimulation mode. There are 9 levels in the stimulation mode. From level 1 to level 4, it automatically advances to the next level after 45 seconds. Once the 9 levels are completed, you can progress to the extraction mode. There are 6 levels in extraction mode.

Weaken - Enhance key

You can also manually increase or decrease the levels in any of the modes to adjust to your requirement. The greater the level higher is the suction. (Research shows the suction is more effective in the most comfortable situation/ level).

Mode Key

Press  button to change between stimulation, extraction and residual milk extraction mode. Residual milk extraction mode is to remove all buffer milk after milk extraction. This is very important for the health of the mother.

Warning

- Please read the instruction fully and carefully before use.
- Do not wash the electrical/suction unit in water or any other liquid.
- Do not sterilize the electrical/suction unit.
- Sterilisation of the upper cover and connecting tube is not recommended. To clean use normal water and blow dry . Make sure there is no water or moisture inside the tube before using the breast pump.
- Make sure there is no water or moisture in the silicone parts before using the breast pump.
- Do not use any other adopter other than the one provided.
- In case you want to replace the adopter. Please use AC adopter of 110-240V input and DC6V,1A output.
- Make sure your hands are dry before operating the electrical/suction unit.
- Damage caused due to water in the electrical unit will not be covered under warranty.

Troubleshooting

⚠ The suction is weak or no suction

- Check whether the suction silicone and the upper cover are sealed.
- Check whether the horn mouth silicone is fixed properly (no air gaps)
- Check whether the Silicone valve is fixed properly.
- Check whether the connecting tube and the tube connector are tightly fixed.
- Check whether there is any fold or damage in the connecting tube.

While extracting, the mother should sit upright. Do not lean forward or lay on the side which might cause the breast milk to flow back wasting your babies valuable feed.

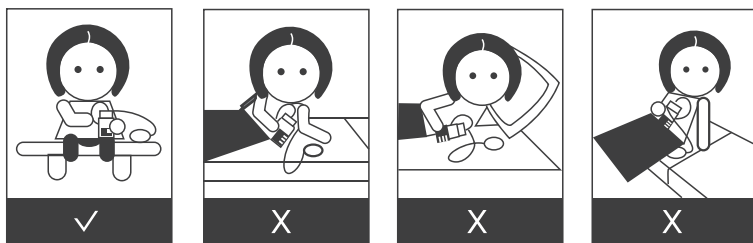

Please dry the interiors and the connecting tube thoroughly before using. This may affect the working of the breast pump and might even cause damage.

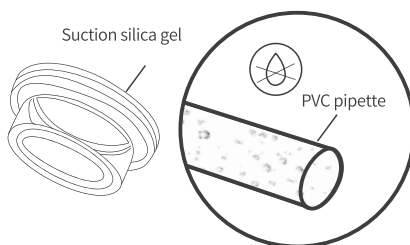

Storage and Heating of Breast Milk

Storage

After extracting close the container tightly and refrigerate the breast milk immediately. (Refrigerator compartment or freezer)



Heating

After defrosting, use a bottle warmer or place bottle in boiling water to heat breast milk instead of microwave oven, to avoid loss of nutrients.

Attention

- To defrost, put the bottle in the refrigerator compartment.
- Gently shake the feeding bottle so as to mix evenly.
- Do not put the frozen breast milk directly into the microwave or boiling water, this may result in loss of nutrients.
- Do not freeze the defrosted milk again.
- Do not mix fresh and defrosted milk.

Sterilisation

Note : The electrical/suction unit and the adopter should not be sterilised.

Please refer to the below instructions.

- **Microwave Oven:** Please use sterilisation container or bag when using a microwave to sterilise. There must be water in the container when heating milk.
- **Boil sterilisation:** Put the components in boiling water for about 10 minutes. Make sure the water level is not lower than the components, in order to avoid damage to the components due to direct contact to heat.

Imported & Marketed By:

Brainbees Solutions Pvt Ltd
Rajashree Business Park, Plot No: 114,
Survey No. 338, Tadiwala Road,
Near Sohrab Hall, Pune 411 001

Customer Care :

☎ 020 - 46608179
✉ customercare@brainbees.com

Customer Care Address:

Same as Importer's address

Made in India