

Age Group

0+

## User Manual

## Babyhug 6-in1 Steriliser Steamer cum Warmer

Style Code: FNBA025



Auto shut off



Kills Bacteria  
& Germs



220-240V AC, 50-60Hz, 500W

# babyhug®

steam sterilizer cum warmer

- 6 Bottles Capacity
- Sterilizing Cycle Within 9 Minutes

Please read the instructions manual prior to using the bottle and food warmer to ensure correct operation. Keep it in a safe place after reading.

CONTENTS

Sr. No.	Table of Contents	Page No.
1	Parts -----	3
2	Technical Parameters -----	4
3	User Guide	
	3.1 Sterilization -----	5
	3.2 Warming Baby Bottle -----	5
	3.3 Warming Food -----	5
	3.4 Steamer -----	6
	3.5 Juicer -----	6
	3.6 Egg Boiler -----	6
4	Cleaning and Maintenance -----	7
5	Caution -----	7
6	Address / CC details -----	8

## Part List

1. Sterilizer Cover
2. Accessory tray
3. Stand
4. Bottle tray
5. Bottle Chamber
6. Removable steamer cover lid
7. Steamer Cover
8. Juicer
9. Steamer bowl
10. Egg tray
11. Heating base

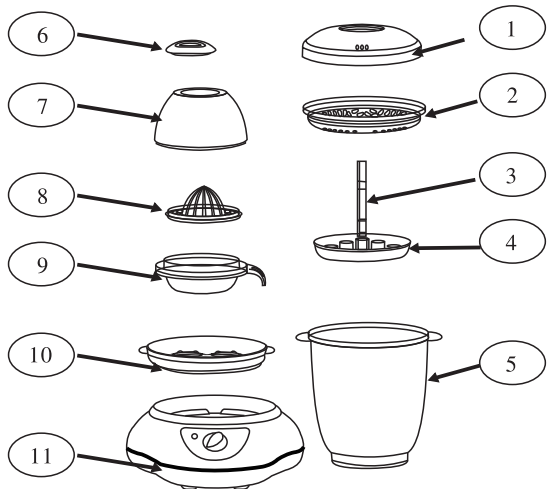

12. Indicator Light
13. Warm milk
14. Warm food
15. Sterilize
16. Cook Eggs

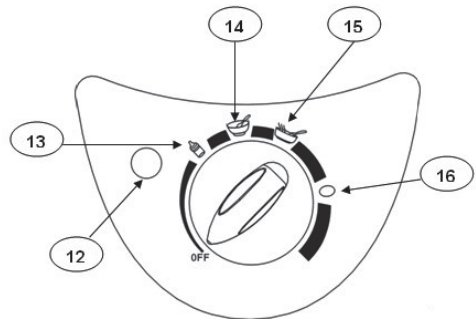

## Technical Parameters

Supply Voltage	AC 220V-240V, 50Hz-60Hz
Power Consumption	500W
Sterilization Time	About 90 ml, 9 minutes
Temperature Range (Bottle Warming)	40°C-50°C
Temperature Range (Food Warming)	50°C-100°C
Available Time Range for Food Warming	
Water : 260ml water degree : 28°C Milk : 240ml milk degree : 25°C	Time 5min, milk degree 40°C
Water : 330ml water degree : 28°C Milk : 150ml milk degree : 25°C	
Water : 100ml water degree : 28°C Milk : 240ml milk degree : 5°C	
Water : 150ml water degree : 28°C Milk : 150ml milk degree : 5°C	

## Multi Functions use of Warmer



Care Support



Multifunctional



From the first day of life



Fits all types of bottles



Sterilizer



Milk Warmer



Baby food warmer



Egg steamer



Juicer



Built-in thermostat

## User Guide

### Sterilising:

Steam sterilization is proven to be the most effective way to remove harmful germs. The intensive heat of the steam eliminates harmful bacteria from the food. Besides sterilization, steaming process can also be used to warm your baby's food and milk without losing the nutrients and also for keeping the food warm.

1. Secure bottle chamber to heating base and pour about 90ml of clean water into the heating base
2. Invert the bottles UPSIDE DOWN in the bottle tray and place them into the bottle chamber. This is important to keep the bottle UPSIDE DOWN so that the steam can enter the bottle freely. Ensure to place the sterilizer horizontally.
3. Place the accessories tray to the bottle chamber and close the sterilizer lid securely.
4. Connect the plug to power source and turn the switch to  and the indicator will light up while heating. It switches off automatically at the end of the cycle approximately 9 minutes.
5. Switch it off & let it cool down. Disconnect from power.
6. After the sterilizer cool down use a clean tong or any other clean & safe method to take out the accessories & bottle
7. Now your bottles are sterilized and ready to use for your baby

### Attn:

The sterilized items might be extremely hot. Do not try to remove them with bare hands as this may cause burn injuries. Please wait till it cools down.

## Warming The Baby Bottle

1. Pour clean water into the heating base
2. Place the steamer cover over the heating base
3. Place the baby bottle with milk into the steamer bracket through the opening of cover
4. Connect the plug to power source and turn the switch to  and the indicator will light up while heating. It switches off automatically at the end of the cycle

## Warming Food

1. Remove all accessories from the main unit, including the steamer bowl
2. Pour about 100ml of clean water into the heating base
3. Position the steamer bowl on the heating base
4. Add the baby food in the steamer bowl
5. Position the steam cover with the removable steam cover lid on the steamer bowl
6. Connect the plug to power source and turn the switch to  and the indicator will light up while heating. It switches off automatically at the end of the cycle.

## Steamer

1. Remove all accessories from the main unit, including the steamer bowl
2. Fill bottle with 180ml of purified water and pour into the heating base
3. Position the steamer bowl on the heating base
4. Clean the food and cut into small pieces
5. Put the food into bowl and turn the switch to your required time
6. The symbol is for around 12 minutes
7. The end of imprint is around 15 minutes

### Attn:

1. The 100g granule potato heating time is around 15 minutes
2. The 100g granule carrot heating time is around 12 minutes.
3. Always check the food temperature before feeding the baby, by testing some on the back of your hand before feeding

## Juicer

1. Position the steamer bowl on top of the main unit
2. Put the juicer on the steamer bowl
3. Cut citrus fruit into two halves for making juice
4. No need to connect to the power

## Egg Boiler

1. Remove all accessory from the main unit
2. Fill bottle with 100ml purified water and pour into the heating base
3. Position the egg tray on the heating base.
4. Arrange the eggs in the egg tray
5. Position the steamer cover together with the removable steamer cover lid on the egg tray
6. After plugging the unit into the socket, turn the switch to ○

## Cleaning & Maintenance

It is recommended to de-scale/ clean your steriliser every four weeks to maintain its efficiency by removing lime scale.

To reduce lime scale build up, use pre-boiled or filtered water in your steriliser.

De-scale the steriliser by pouring 100ml of vinegar mixed with 200ml of cold water into sterilizer, leave inside the unit until lime scale has dissolved. Empty the unit and rinse thoroughly.

## Caution

- Disconnect the device and allow it to cool down.
- Clean it with a soft cloth or slightly damp sponge.
- The plastic components are not suitable for use in a dishwasher.
- Please do not cover the top lid with cloth when it is working, in order to allow vapor release from the steam hole easily.
- The steriliser should be placed on the horizontal surface when it works.
- Unplug the electrical steam steriliser when not in use.
- Do not remove the lid while the water is boiling. Must not immersed in water for cleaning.
- The appliance is for indoor use only.
- Should not be handled by children.
- If the supply cord is damaged, it must be replaced by the manufacturer, its service agent or similarly qualified persons in order to avoid any hazard.

---

**Imported & Marketed By:**

Brainbees Solutions Pvt. Ltd.

Corporate & Registered Office Address:

Rajashree Business Park, Plot No.: 114,

Survey No. 338, Tadiwala Road,

Near Sohrab Hall, Pune 411001

**For Any Feedback, Contact:**

☎ 020 - 46608179

✉ [customercare@brainbees.com](mailto:customercare@brainbees.com)

**Customer Care Address:**

Same as Importer's address