

### Warning

1. Please read the instructions carefully before using the stroller and keep for future reference. Not following the instruction properly can harm the child.
2. Never leave the child unattended in the stroller.
3. Ensure all locks are securely fastened before using the stroller.
4. Always keep the children away, when folding or unfolding the stroller, to avoid injuries.
5. Do not let children play with the stroller.
6. Use safety harness every time you seat the child in the stroller.
7. The stroller is suitable for children from 0 to 36 months. Backrest should be reclined to the lowest position (flat) while used for babies below 6 months.
8. Check that the stroller body and seat unit attachment devises are correctly engaged before use.
9. This product is not suitable for running or skating.
10. The maximum capacity of the stroller is 15kg, load capacity of the storage basket is 2kg. Please do not over load.
11. Do not add mattress thicker than 25mm.
12. The wheels should be locked while placing or removing the child.
13. The stroller should be used for only one child at a time.
14. Any load attached the handles, back rest or sides of the stroller will affect the stability of the stroller.
15. Please avoid using the stroller in uneven roads.
16. Avoid using or storing the stroller in wet, cold or high temperature and keep away from fire or strong heat source.
17. To avoid serious injuries from falling down or sliding out, secure the safety harness when ever you seat the baby in the stroller.

### Maintenance

- Wipe the fabric lightly with natural soap and cold water and let it air dry. Babyhug multi purpose cleanser is best recommended
- Do not bleach, press or dry clean the fabric of the stroller.
- Wipe the metal and plastic parts of the stroller with a wet cloth. Do not use harsh chemicals or bleach for cleaning.
- Keep checking for loose screws, damaged parts and broken threads.
- While assembling and dismantling the stroller, follow the instructions on the user manual carefully.

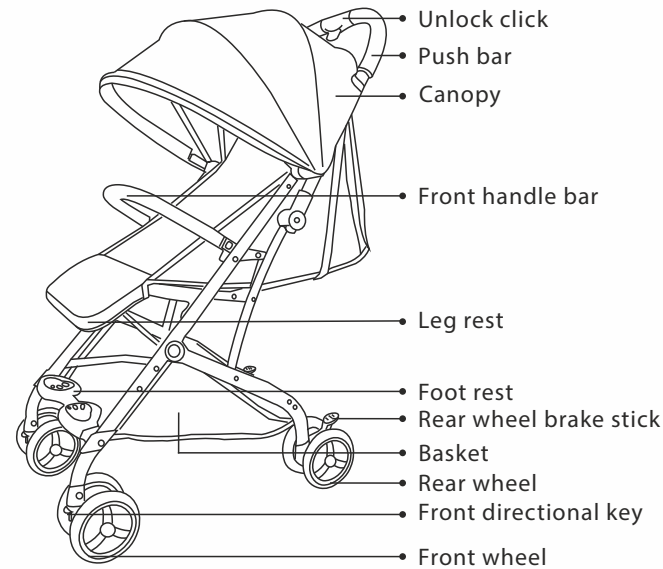

**Imported & Marketed by**  
Brainbees Solutions Pvt. Ltd.  
Corporate & Registered Office Address:  
Rajashree Business Park, Plot No: 114,  
Survey No. 338, Tadiwala Road,  
Near Sohrab Hall, Pune 411 001

**Customer Care No. :**  
02030556310  
**E-mail:**  
customercare@brainbees.com

**Customer Care Address:**  
Same as Importer's address

Made in China

0 to 36  
Months

Carrying Capacity  
Upto 15kg

User's Manual

Babyhug Easy Travel Stroller

Style code - B6ST017

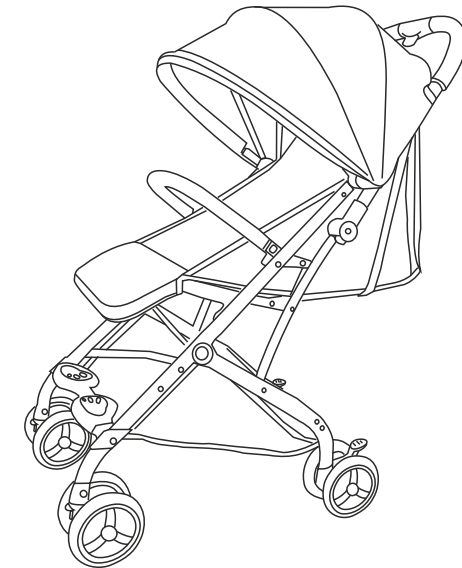

**babyhug™**

baby stroller

- Multi Reclining Positions
- 5 Point Safety Harness
- Z fold
- Easy trolley movement with handle after folding

Please read the manual thoroughly before using. Keep the manual for any future reference.

## Installation

### Opening the Stroller

Take off the close coupler, grip the handle bar and pull it up and then back, open the baby stroller, when the click sound is heard, it is in place.

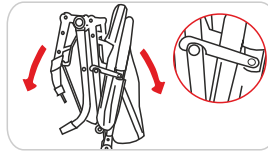

### Assembling and Use of Front Wheel

As shown, insert the axle in to the front wheels group, once you hear the click sound, installation is done. When disassembling, press the key and pull the wheels down.

Swivel and fixed: push the fixed key up to lock swivel. Opposite way will make the wheels swivel again.

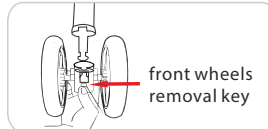

### Assembling and Use of Rear Wheel

Insert the rear wheels in to the rear leg tube. Once you hear the clicking sound the wheel is fixed.

To remove, lift the key up and pull the wheels off.

Brakes: Push down the brake link to stop and release to move again. Make sure to secure the brakes on both sides.

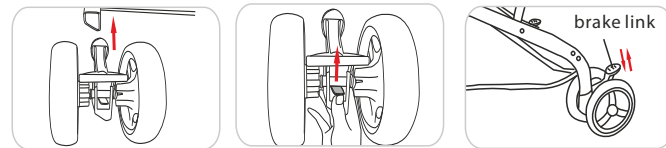

**Attention:** Once you lock the brakes, push the stroller gently to make sure the brakes are properly locked.

### Assembling and Use of Front Hand rest

Plug the hand rest into the installing holes on both sides. Once you hear the clicking sound on both sides the handle is fixed. To remove, press the key on both sides simultaneously and pull the handle out.

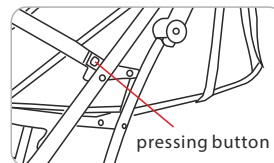

## Assembling and Use of Canopy

As shown in the picture, plug both ends of the canopy bar in to the bar mount. To remove, press the round button indicated in the picture and pull out.

Pull down or push up the canopy as per requirement.

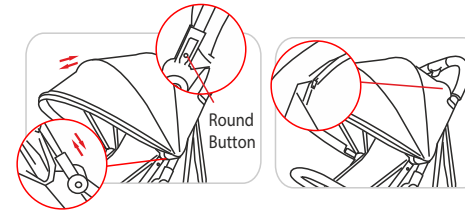

### Backrest Adjustment

Pull the belt with one hand, as shown in the picture, and at the same time push the adjusting key upwards or down to change the angle of the back rest.

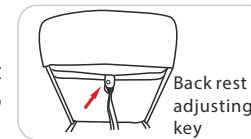

### Warning

While adjusting the back rest to seating position, the rear button has to sealed. When you adjust the back rest to flat position unlock the button. While folding the stroller always keep the button sealed. Stroller cannot be used in seating position for children below 6 months.



### Leg rest adjustment

As shown in the picture, press the adjusting key in the leg rest and push it down or up as per requirement.

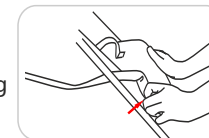

### Leg rest adjustment

As shown in the picture, press the adjusting key in the leg rest and push it down or up as per requirement.

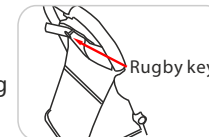

### Rear Canopy

As shown, unzip the rear canopy and roll the fabric to fix it with the rugby button.

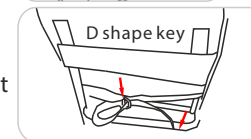

## Cushion Pads

As shown in the picture, the base cushion pad can be removed and washed. First remove the leg rest, then release the 2 D button on the back. Finally release the buttons near the side hand rest to remove the cushion pad.

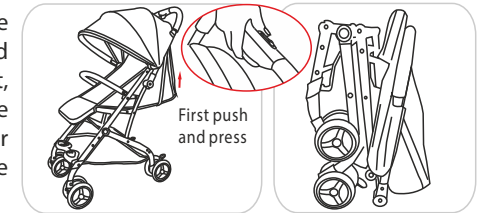

## Folding the Stroller

Before folding, lock the wheel brakes, keep the backrest in the erect position and fold the canopy. Push the unlock button on the handle towards left and press down to fold the stroller. Please note the front wheels have to face outside during folding.

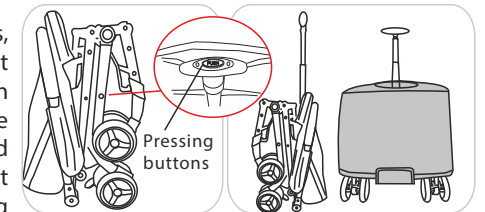

## Drag Link

As shown in the picture, once the stroller is folded, pull the drag handle by pushing the button down and pull like a trolley to move the stroller. Once done press the button and push the handle down.



## 5 Point Safety Harness

1. Buckle the four belts as shown in the picture, then insert them in the middle button. When you hear the clicking sound the harness is fixed.
2. Adjust the shoulder belts and waist belts for perfect fit.
3. Press the button in the middle to release the harness.

**Note:** Fasten the harness every time the child is seated in the stroller.