

**Imported & Marketed By:**

Brainbees Solutions Pvt Ltd  
Corporate & Registered Office Address:  
Rajashree Business Park,  
Plot No: 114, Survey No. 338,  
Tadiwala Road,  
Near Sohrab Hall, Pune 411 001

**Customer Care**

☎ 020 - 30556310  
✉ [customercare@brainbees.com](mailto:customercare@brainbees.com)

Made in China

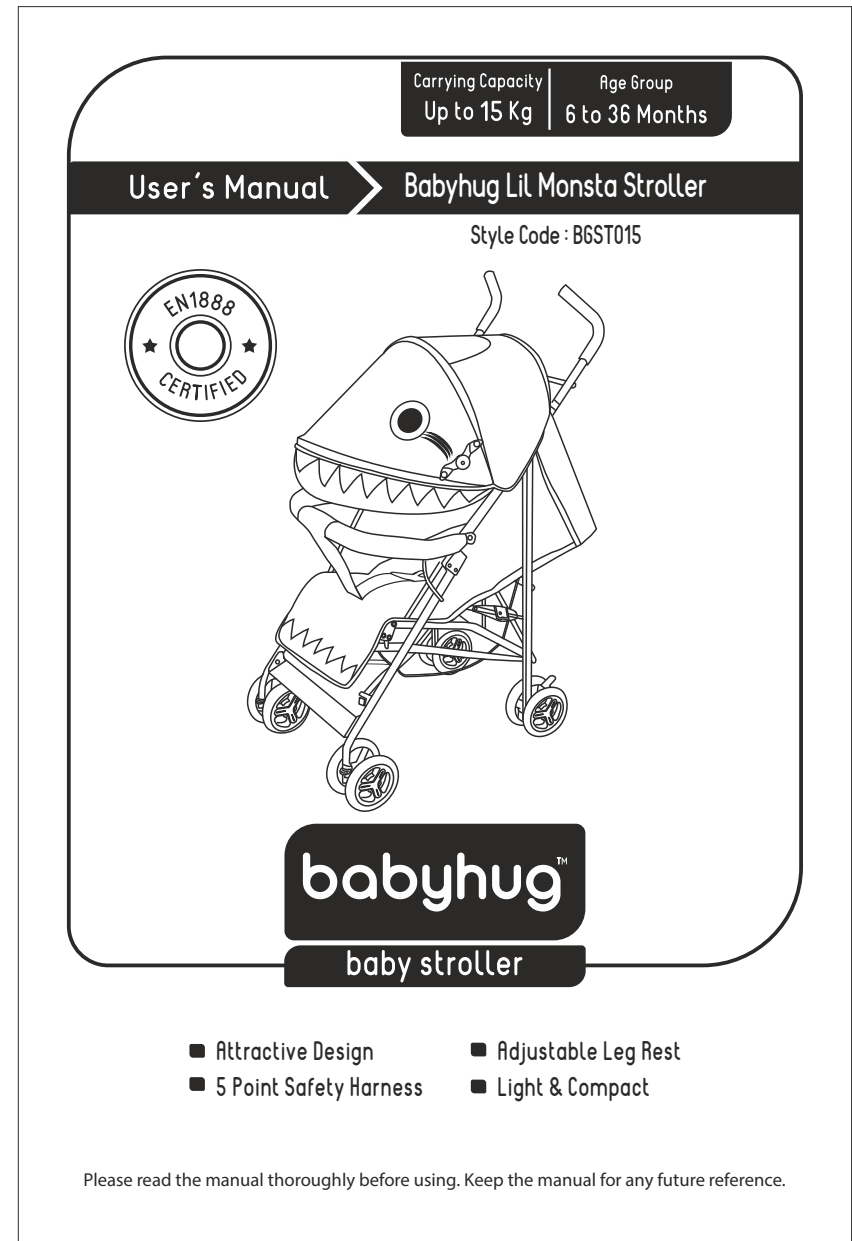

## Component

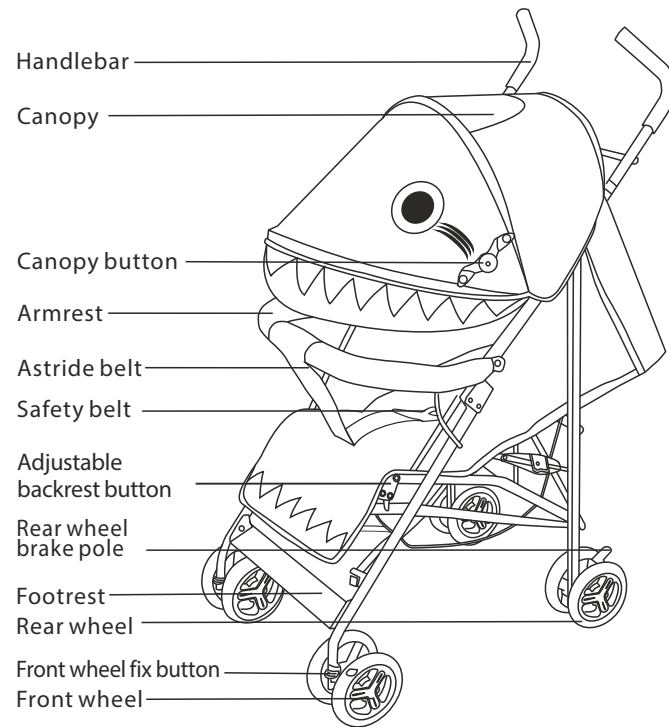

01

## Opening and Folding the Stroller

**Open Frame:** Unhook the folding locks in the sides. Open the frame and press the lock in place.

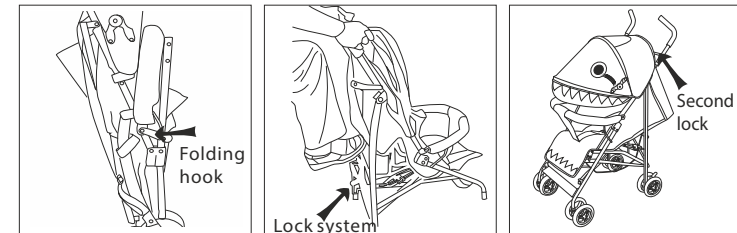

**Close Frame:** Lock the wheels and close the canopy. Open the lock and pull it up with your foot, simultaneously pull the second lock with your hand. After folding, buckle the side folding hook.

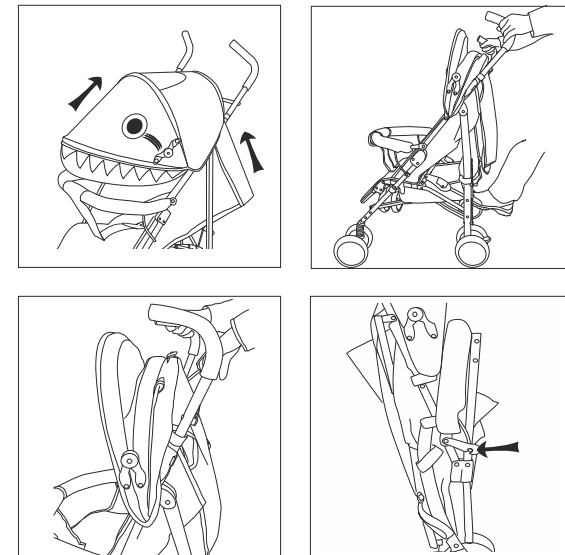

02

### Install and remove the wheels

**Installing and removing the front wheels:** Insert the front wheel group into the cover core of front foot tube, when the barb of cover core of front wheel spring out, the wheel is fixed. If you need to remove the front wheel, just hold the barb and pull out the wheels, then the front wheel group will come out.

**Installing and removing the rear wheels:** Insert the rear wheel group into the back foot tube, when the spring piece come out and lock is done. To remove, press down the spring piece and pull out the wheels.

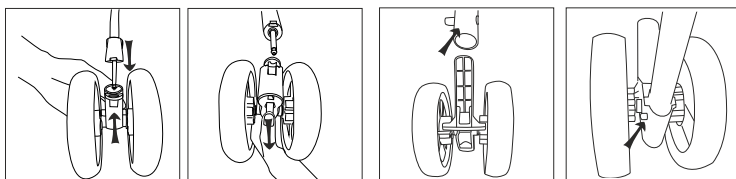

### Usage

1. The front wheel can either be in swivel mode or fixed. Push the button down for swivel movement and release to lock.
2. Brake: To stop the stroller, press the button as shown in the picture.
3. Canopy: When required, open the canopy by pushing it forward as shown in the picture.
4. To adjust the angle of the backrest, press the adjustment button shown in the picture and choose the desired angle. The backrest can be adjusted to 5 different positions.
5. To adjust the leg rest, press the adjustment button and change the position.

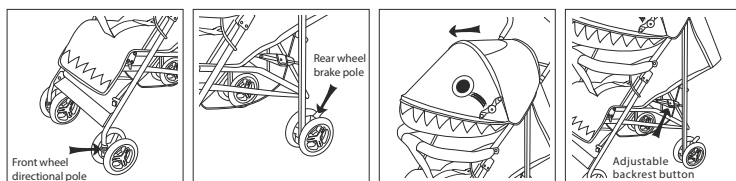

### 5 Point Safety Harness:

1. Buckle the four belts as shown in the picture, then insert them in the middle button. When you hear the clicking sound, the harness is fixed.
2. Adjust the shoulder belts and waist belts for perfect fit.
3. Press the button in the middle to release the harness.

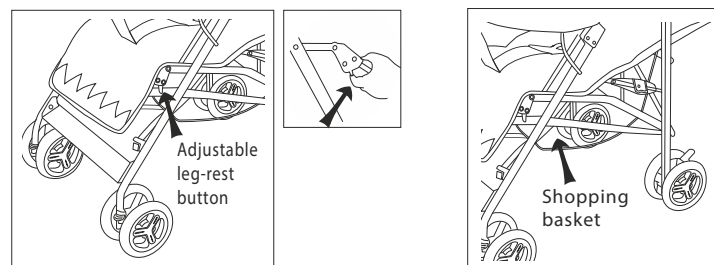

**Note:** Fasten the harness every time the child is seated in the stroller.

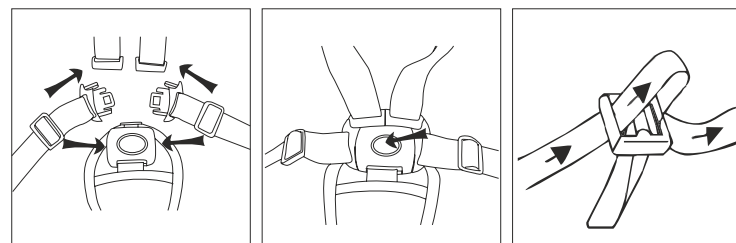

### Warning

- Always keep the stroller away from fire.
- Please read the instruction carefully before using the stroller. Keep the manual safe for future reference. Not following the instruction properly can harm the child.
- Never leave the child unattended in the stroller.
- This stroller is not suitable for children below 6 month of age. The suitable age for the using the stroller is 6 to 36 months.
- Any load attached the handles, back rest or sides of the stroller will affect the stability of the stroller.
- Do not add mattress thicker than 25mm.
- Ensure all locks are securely fastened before using the stroller.
- Always use the safety harness.
- Always keep the children away, when folding or unfolding the stroller, to avoid injuries.
- Do not let the children play with the stroller.
- Check that the stroller body and seat unit attachment devises are correctly \ engaged before use.
- This product is not suitable for running or skating.
- The maximum capacity of the stroller is 15kg, load capacity of the storage basket is 2kg and pocket is 0.2kg. Please do not over load.
- The wheels should be locked while placing or removing the child.
- The stroller should be used for only one child at a time.
- Please avoid using the stroller in uneven roads.
- Avoid using or storing the stroller in wet, cold or high temperature and keep away from fire or strong heat source.

### Maintenance

- For cleaning the fabric, remove the screws and take out the fabric out of the stroller.
- Wipe the fabric lightly with natural soap and cold water and let it air dry. Babyhug multi purpose cleanser is best recommended
- Do not bleach, press or dry clean the fabric of the stroller.
- Wipe the metal and plastic parts of the stroller with a wet cloth. Do not use harsh chemicals or bleach for cleaning.
- Keep checking for loose screws, damaged parts and broken threads.
- While assembling and dismantling the stroller, follow the instructions on the user manual carefully.